



Dual Z Axis Lead Screw Upgrade Kit with Stepper Motor Replacement for Ender-3 Ender 3 Pro Ender 3 V2 3D Printer

[Read More](#)

SKU: CR23-3256801536207604

Price: 499.00 DH

Stock: instock

Categories: [Pièces de Rechange](#)

Tags: [#technology](#), [3d](#), [Creality](#), [fdm](#), [Filament](#), [print](#)

Product Description

- Model Number: Dual Z Axis Upgrade Kit
- Item Type: Hardware Parts/Machine Parts
- Brand Name: Creativity
- Origin: Mainland China

Advantage:

1. Increased Accuracy - Compared with original structure, dual Z-axis kit reduces the layer ripple caused by Z-axis vibration, increasing the printing performance of 3D printer.
2. Smooth Running - Upgrade Single Z-axis structure to a dual Z-axis structure, avoiding backlog of filament thoroughly, which improves stability of 3D printing.
3. Easy Leveling - Both ends of the X axis are raised and lowered synchronously, which reduces difficulty and frequency of bed leveling obviously.

4.Stable Performance - Compared with Closed Timing Belt, this 3D printer parts set still retains the design of stepper motor to ensure screw rod smooth operation.

5.Easy Assemble - No need to modify or weld the machine, no need to replace motherboard, this 3D printer accessories kit comes with instructions, could be assemble quickly.

Suitable for: Ender 3 dual Z axis Upgrade Kit compatible with Ender-3/3S/Pro/Ender 3 Neo 3D printer.

Suitable for: CR10 dual Z axis Upgrade Kit is compatible with CR10/CR10S 3D printer.

Specifications:

Item Type: Dual Z Axis Lead Screw Upgrade Kits

Material: metal

Size: package: 520x150x85mm/20.4x5.9x3.3in

Fit: for Ender 3/3S/Pro 3D printer, CR10/CR10S 3D printer.

Note:

Please select the 3D printer you need to upgrade, the Lead screw length and accessories of the two are not exactly the same. Thank you!

Package Include:

1 Set x Dual Z Axis Lead Screw Upgrade Kits+1PC Nozzle Cleaning Copper Brush

Precise and smooth s

Precise and smooth screw has high precision and

The guide rail precision is p3-p7. The repeated

accuracy reaches 0.01mm. High loading ability

running speed meet the high-speed running





42-34 Stepper Motor

With 42-34 Stepper Motor stronger torque,lower noise which ensures operation Precision



All-aluminium Rigid Coupling

Provides torque transmission and alignment



Leading Screw

Apply for T8 lead screw make the print



Z-axis Stepper Motor Mount

It made the motor tighten on the aluminum profile and more stable operation



T8 Leading Screw Bracket

Metal bracket, effectively increasing X-axis load-bearing capacity



T8 Leading

The precise a screw has high repeated position reaches 0.01mm



PRODUCT PARAMETERS

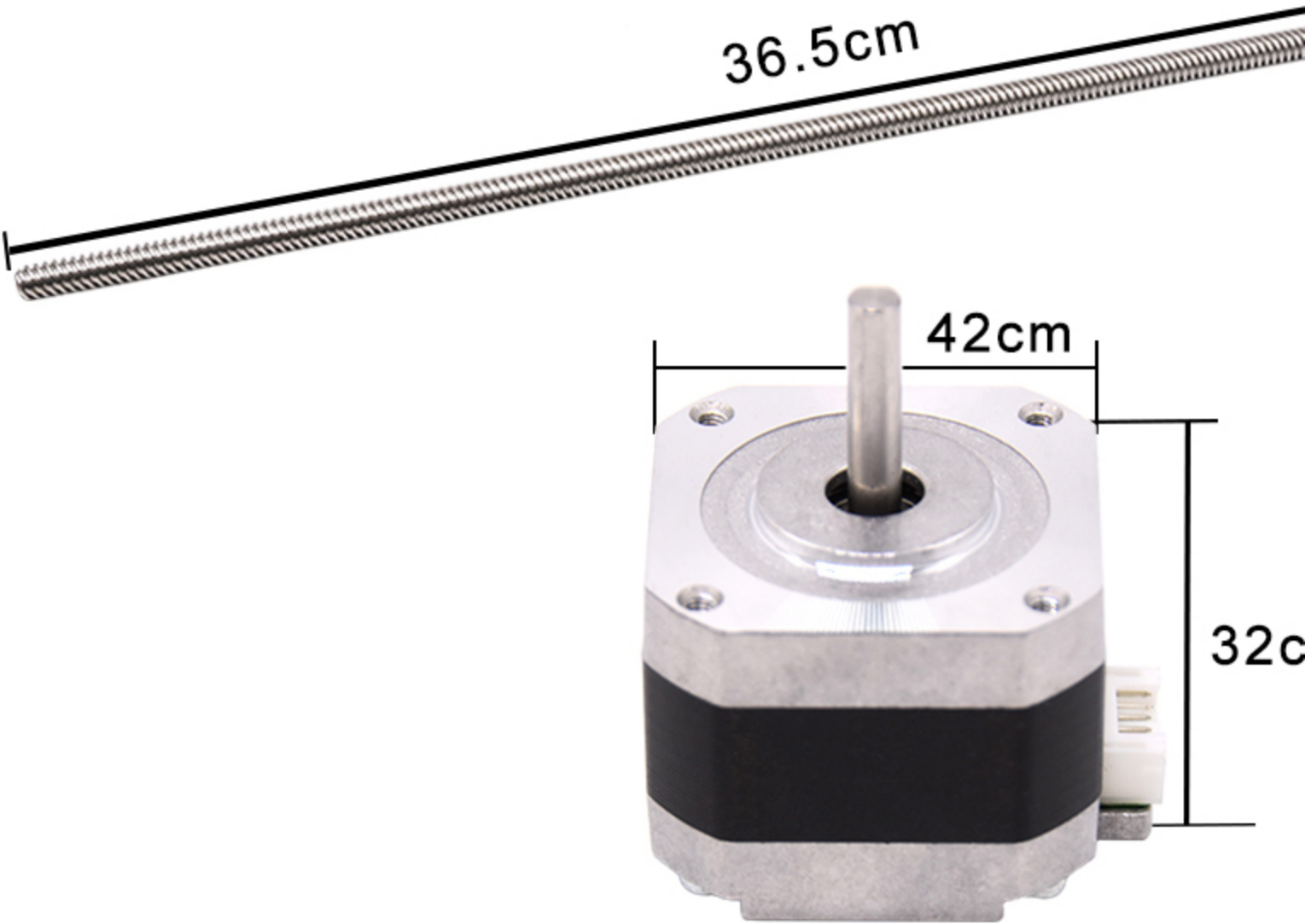

Note: The above data are all manual single batch measurements

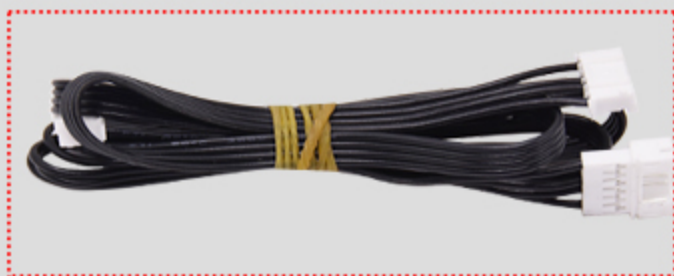
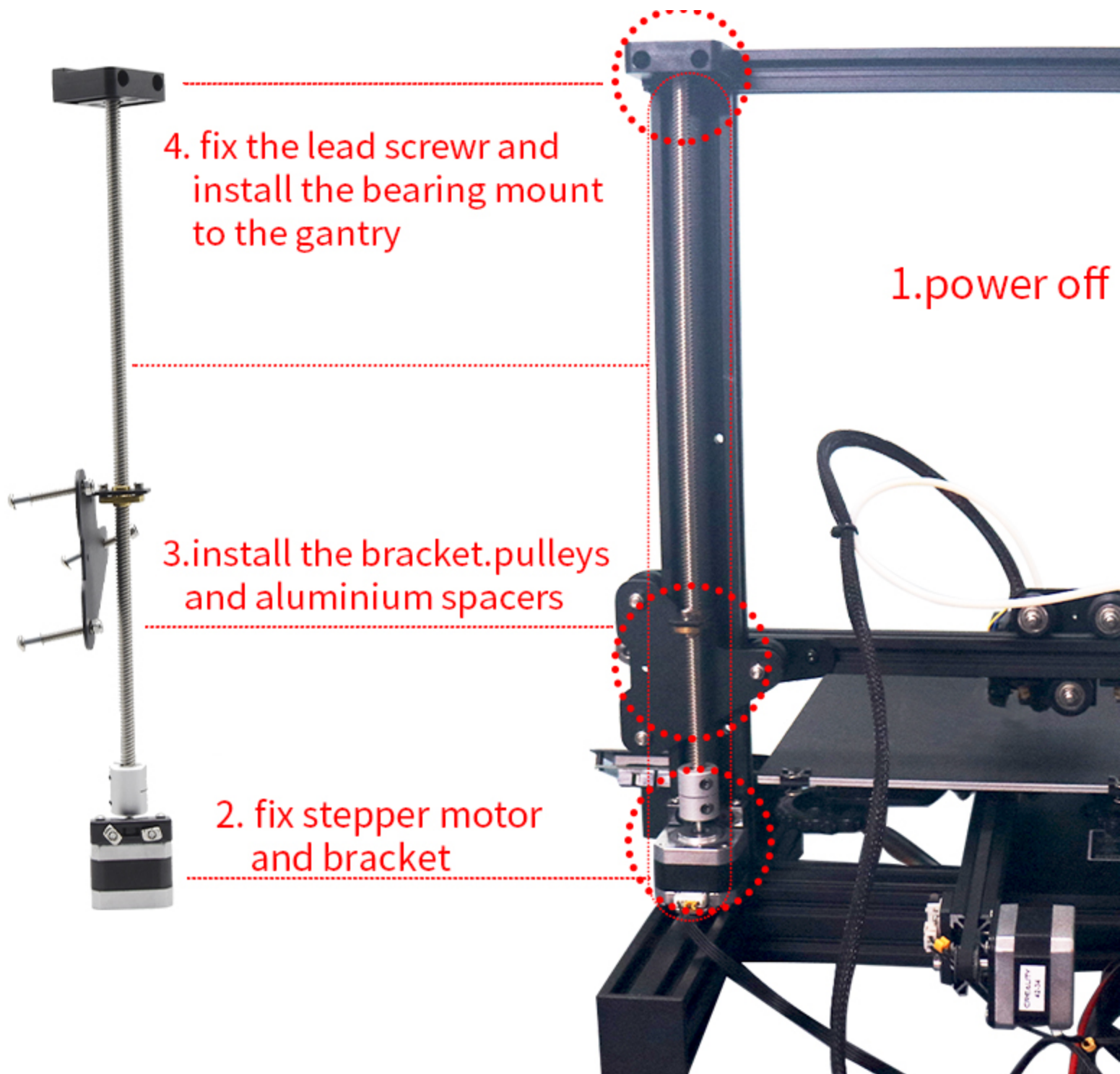

5. connect the stepper cable of motor



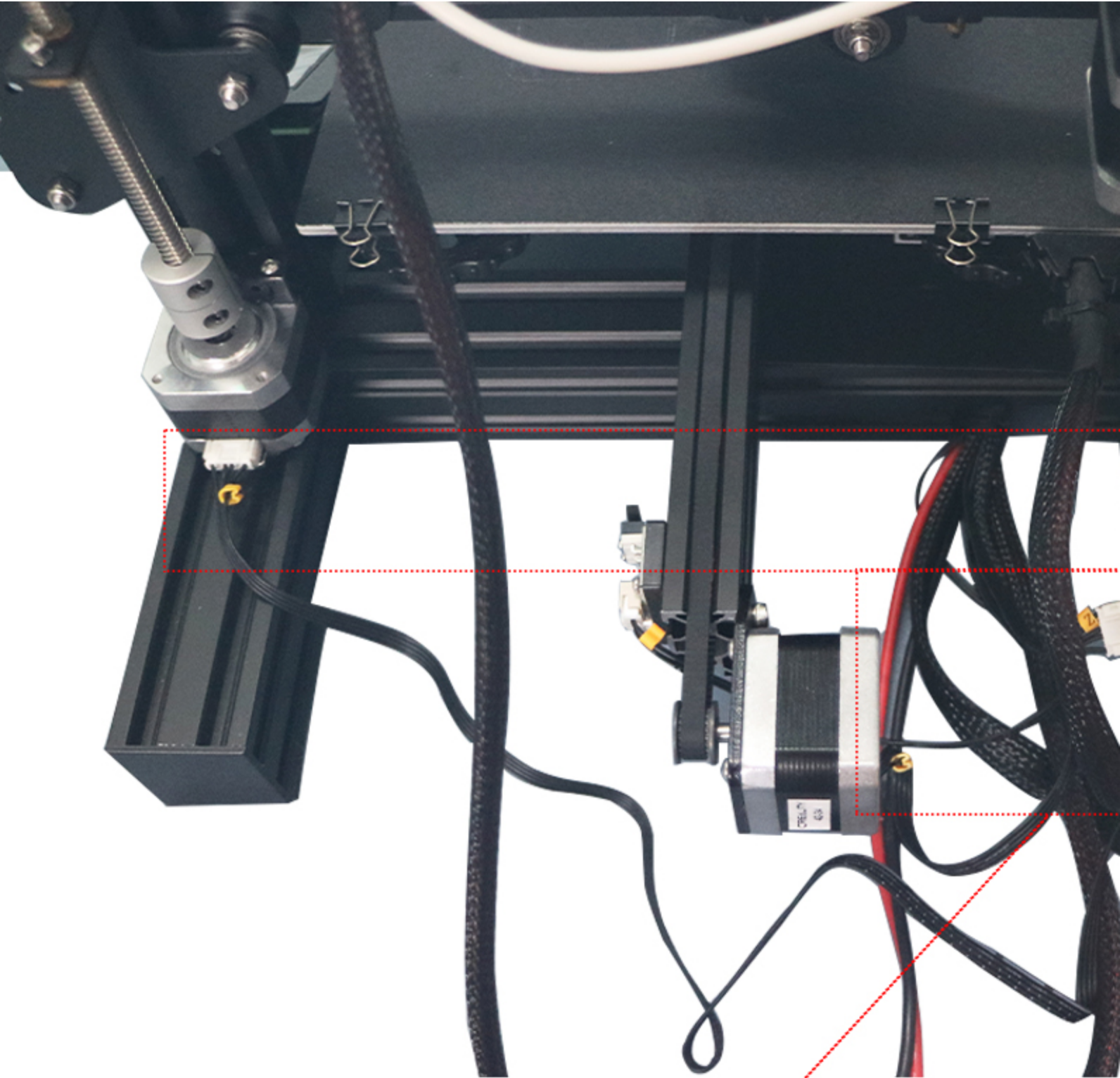

Connect the stepper cable of motor



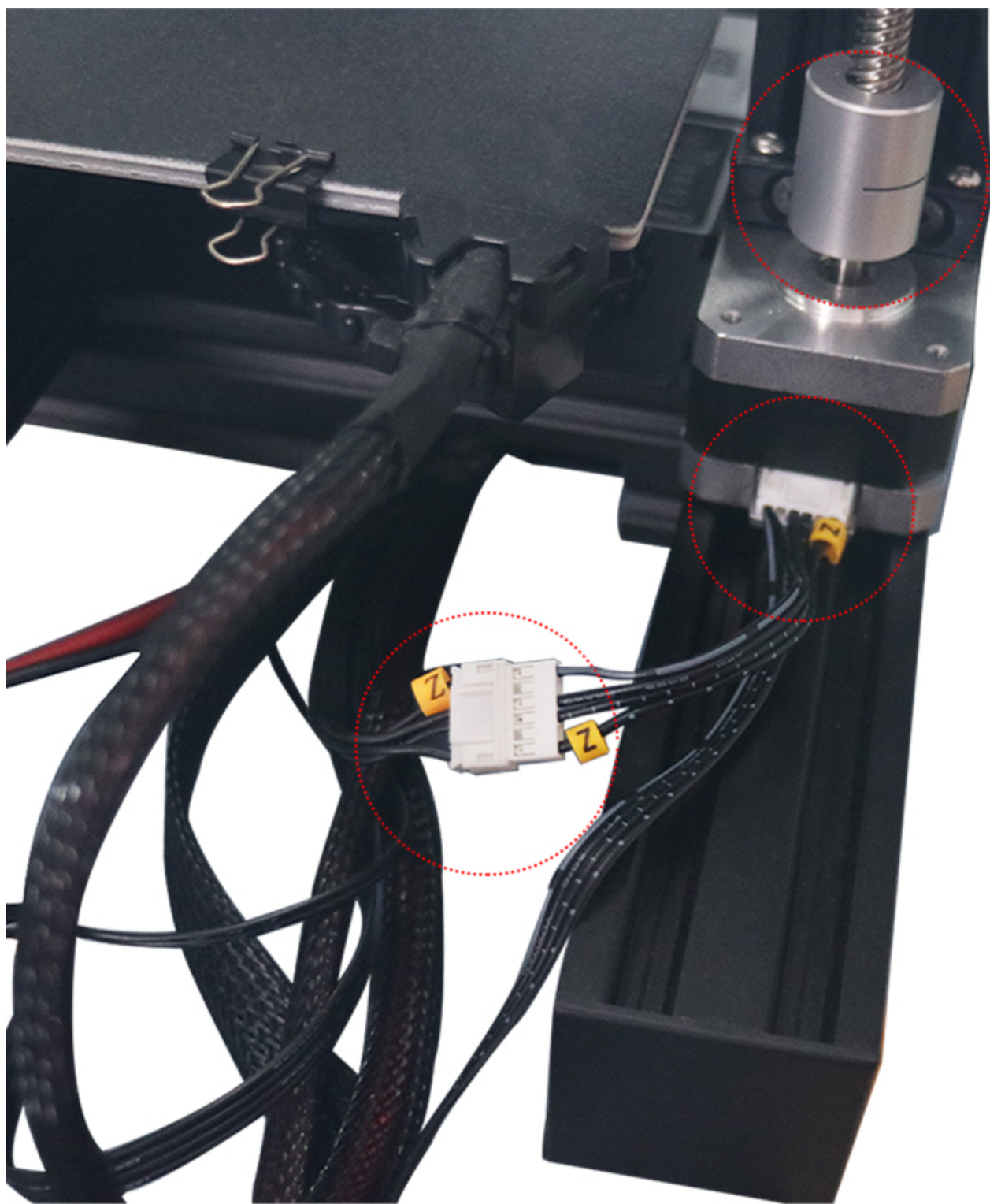

Rich tools, with All-aluminum coupling and a stepper motor
Double Z structure runs smoothly



Creativity



